













PROJECT	<b>ÉÉNGEZINSWONING - Neerveldstraat, OUD-HEVERLEE</b>	
GELEGEN TE	Neerveldstraat 3050 OUD-HEVERLEE (SINT-JORIS-WEERT) <b>5de afdeling, sectie B, nr. 545D, lot 4</b>	INTERPROFESSIONELE ARCHITECTENVENNOOTSCHAP bvba vincent crolla • hugo nicolaes Goossensvest 36c, 3300 TIENEN
BOUWHEER	<b>NV KWADRAAT</b> Culostraat 44 3360 BIERBEEK Chris Holemans gedelegeerd bestuurder	
REF.	3684.05.00 NEERVELD 5 N.18.0305.HN	TEL.: 016/82 56 10 - FAX.: 016/82 56 11 - info@architectencn.be





### arceringen:

-  gevelsteen
-  crepi op isolatie
-  celbetonsteen, Ytong
-  gewapend beton
-  blauwe hardsteen
-  isolatie, PUR
-  isolatie, EPS
-  isolatie, minerale wol
-  volle grond
-  rookmelder

### inplanting

-  klinkers (waterdoorlatend)
-  bouwzone volgens verkavelingsvergunning

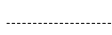

### terreinsnede

-  bestaand maaiveld
-  ontworpen maaiveld
-  as van de weg
-  ref. niveau 30.00
-  nulpaswoning = 29.94





### gevelmaterialen:

- 1.** gevelsteen, lichtgrijs, REGA VDS , toon op toon gevoegd
- 2.** gegolfde dakpan, leikleur
- 3.** aflopen en goten in geprepateerd quartz-zinc
- 4.** blauwe hardsteen
- 5.** aluminium buitenschrijnwerkerij, gitzwart (RAL 9005)
- 6.** aluminium dakrandprofiel, gitzwart (RAL 9005)
- 7.** trespa, gitzwart (RAL 9005)
- 8.** borstwering in gelaagd glas

### referentiepunt woning

-  voorste linkerhoek van de woning = nulpas woning t.o.v. ref. punt op de stoeprand in het verlengde linkerperceelgrens x 300 - y 650 - z 26,5
-  ref. punt op stoeprand 29.675
-  nulpas woning (0) = 29.94 (referentiepeil)

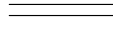
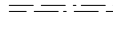
### riolering

-  afvalwaters
-  faecalien
-  regenwater
-  drainering
-  Horizontale RioolDoorvoer

HRD

dossier N.18.0305.HN	<b>EENGEZINSWONING Neerveldstraat, OUD-HEVERLEE</b>	
<b>ONTWERP</b> <b>ref. KWADRAAT - 3684.05.00 NEERVELD 05</b>		

GELEGEN TE	Groot Neerveld 15 3050 OUD-HEVERLEE (SINT-JORIS-WEERT) <b>5de afdeling, sectie B, 132/2/deel, lot 4</b>	
BOUWHEER	<b>NV KWADRAAT</b> Culostraat 44 3360 BIERBEEK Chris Holemans gedelegeerd bestuurder	voor akkoord
ARCHITECT	INTERPROFESSIONELE ARCHITECTENVENNOOTSCHAP bvba vincent crolla • hugo nicolaes Goossensvest 36c, 3300 TIENEN  TEL.: 016/82 56 10 - FAX.: 016/82 56 11 - info@architectencn.be	Hugo Nicolaes

GEMEENTE		
WIJZIGINGEN	<b>UITVOERING</b>	<b>04/04/2019</b>
	juiste afmetingen veluxen	24/04/2019
	aanpassing gevelsteen	22/05/2019
	aanpassing draairichting raam badk 2 en zolderraam	24/09/2019
	maat metselwerk tussen ramen tv-ruimtes NV 5 en 6	01/10/2019
	verplaatsen RW putten	24/02/2020
	carport 2 palen	06/07/2020
	trap gelijkvloers > verdieping: 90 cm breed	03/09/2020

datum	26 maart 2018	12	aantal pagina's
meeteenheid	cm	Daniël Laermans	getekend door
schaal	1/50, tenzij anders vermeld	Katarina Mikusova	



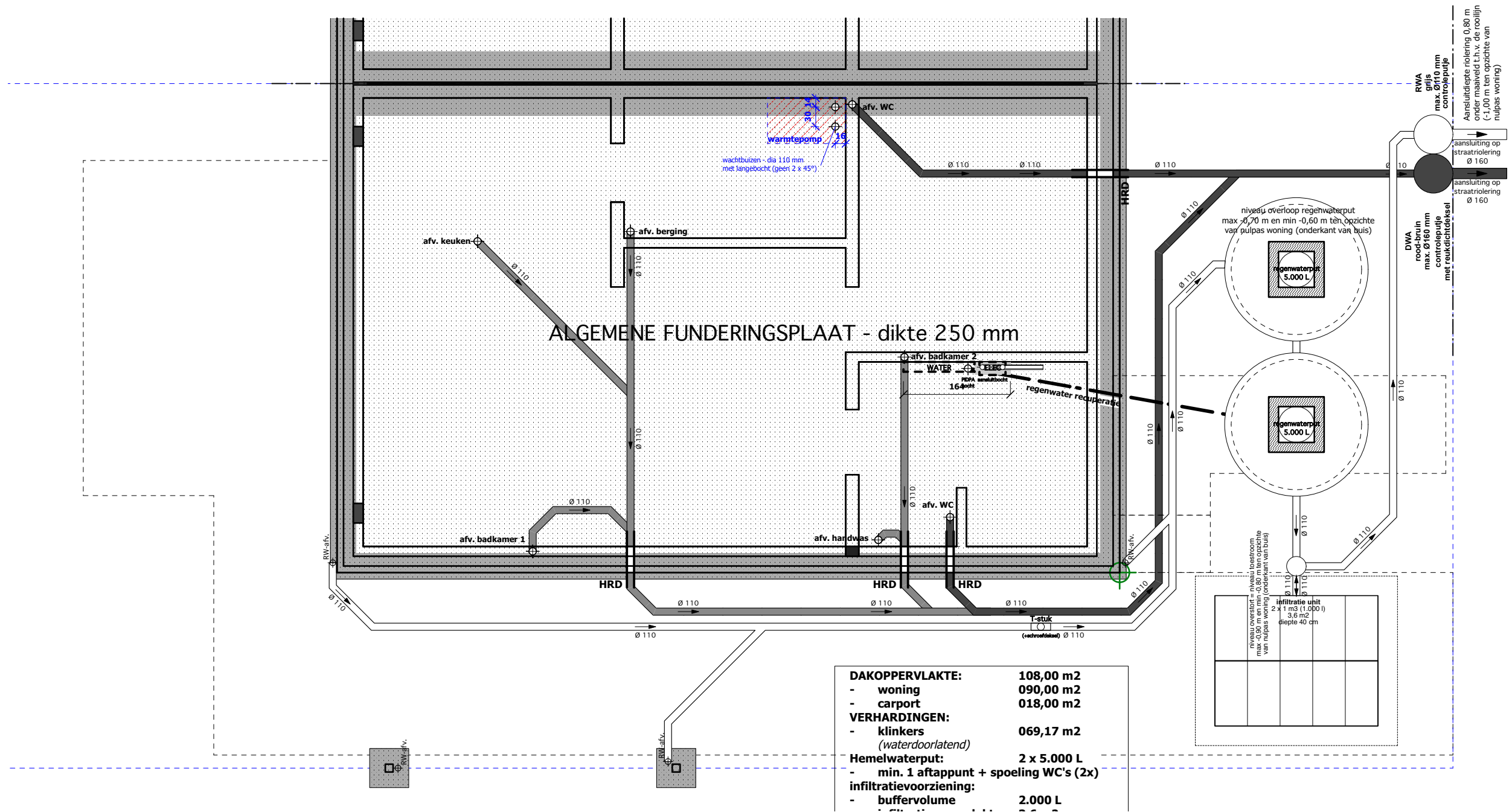



alle blokken met dikte 15 cm in C4/550  
 alle blokken met dikte 20 cm in C3/450  
 woningscheidende muren met dikte 20 cm in C5/650

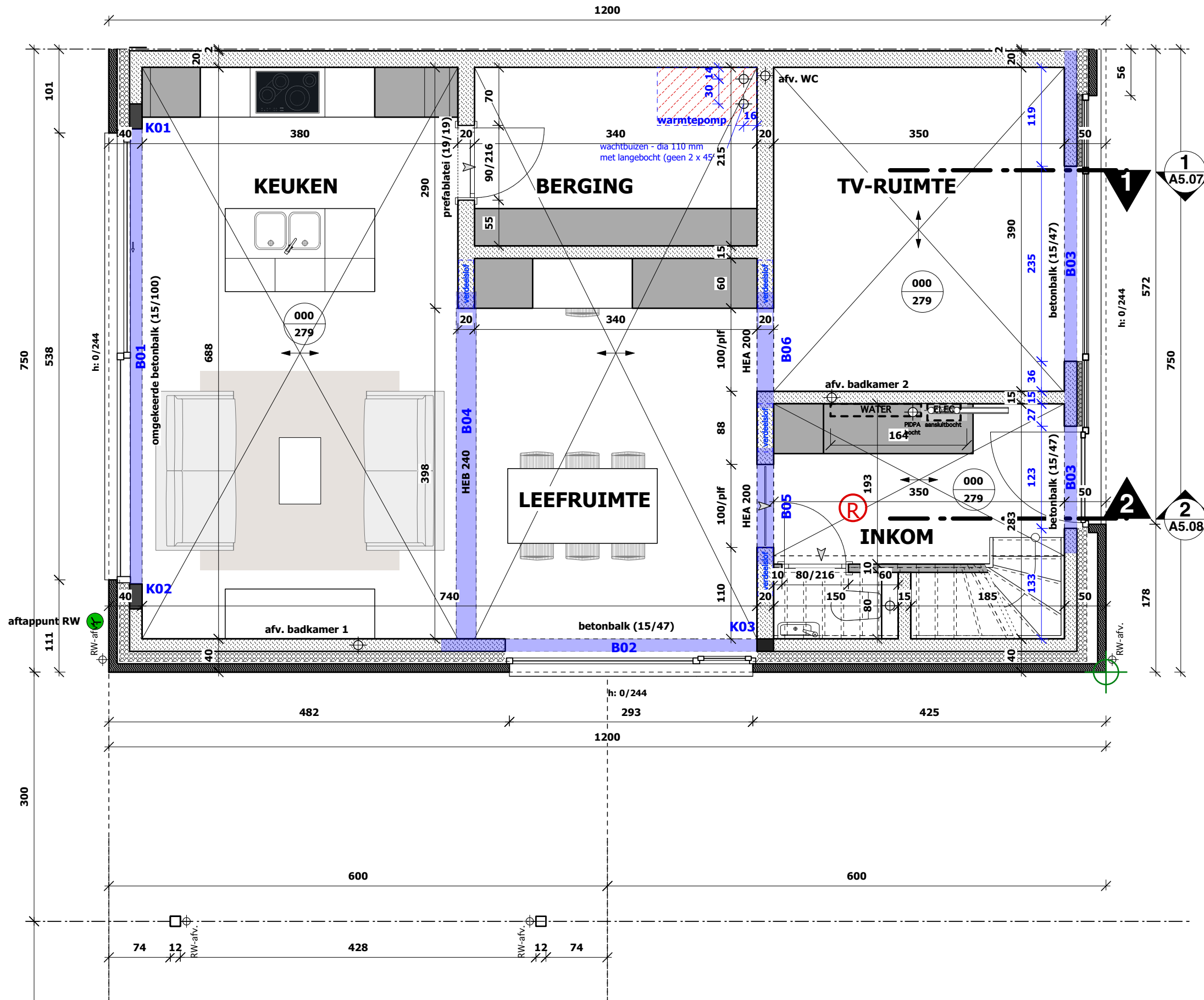

alle blokken met dikte 15 cm in C4/550  
 alle blokken met dikte 20 cm in C3/450  
 woningscheidende muren met dikte 20 cm in C5/650

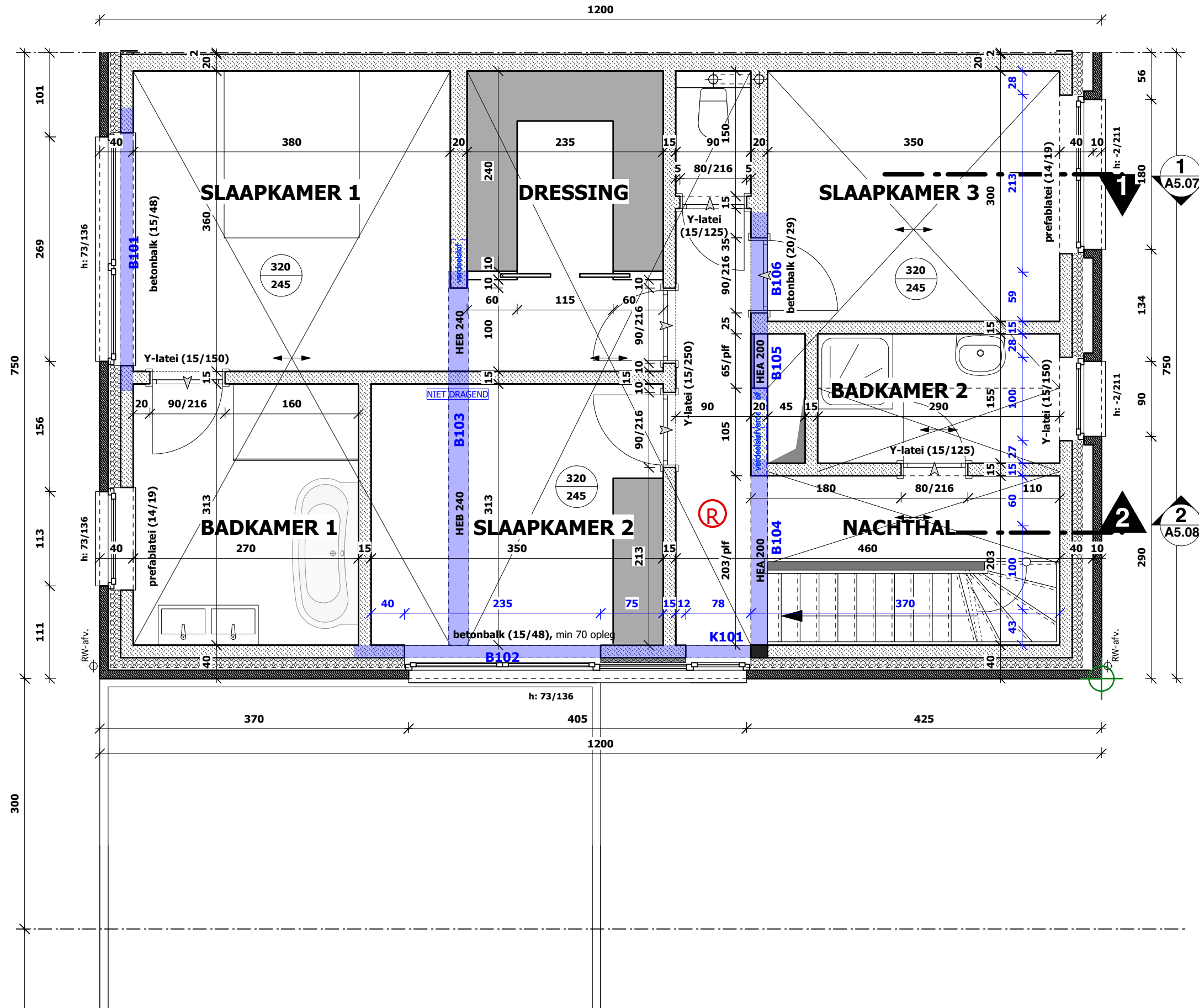



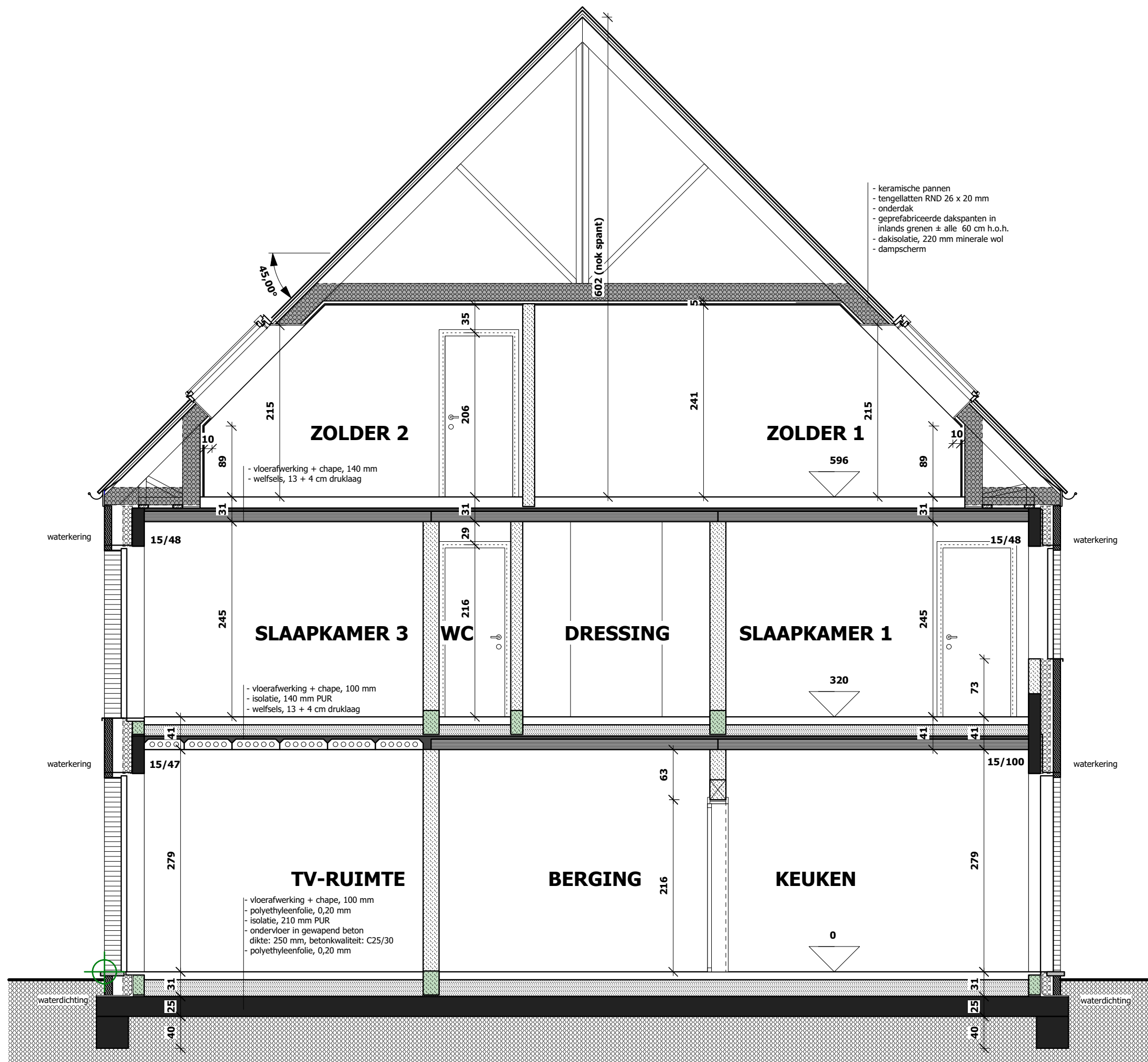

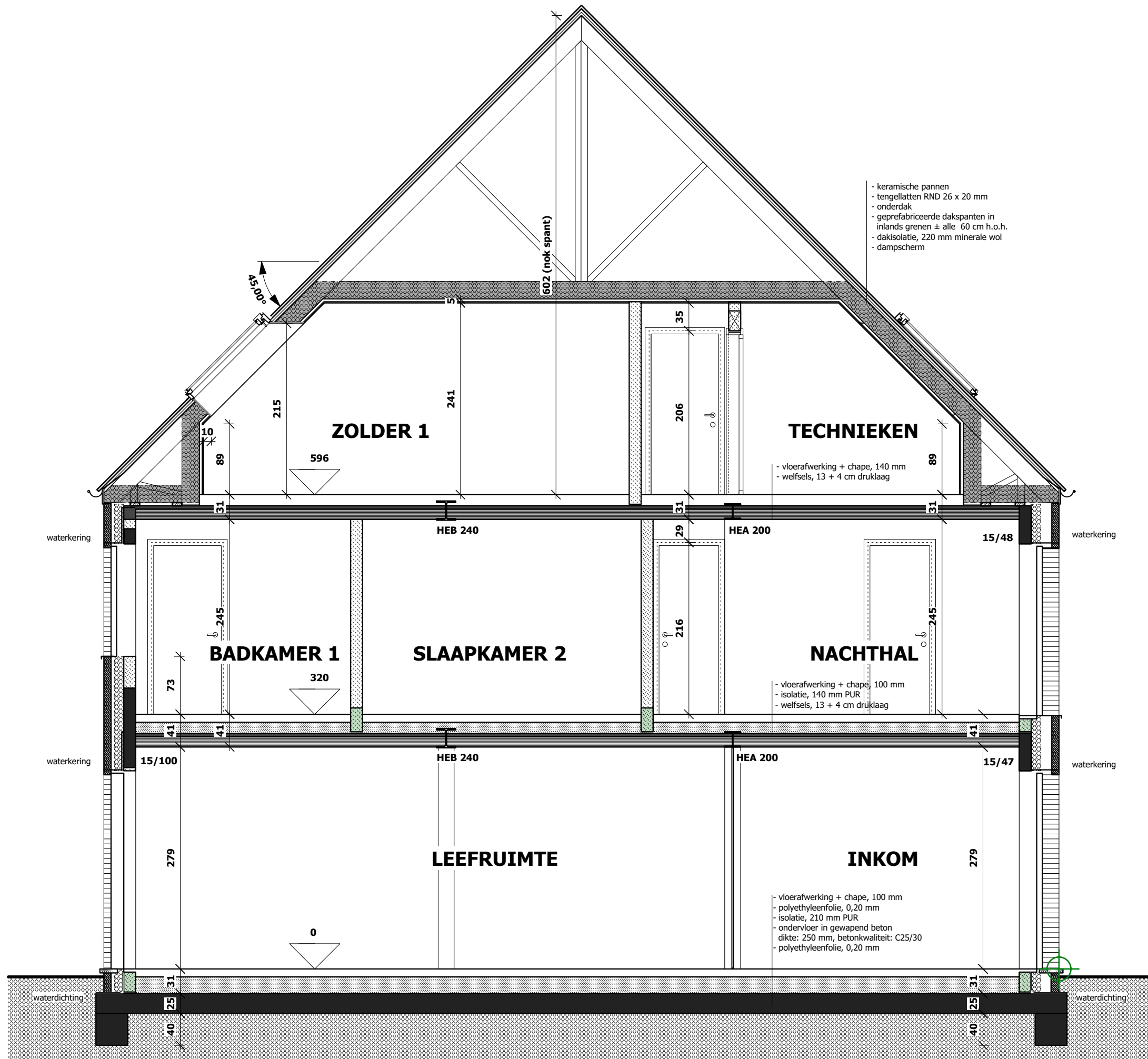

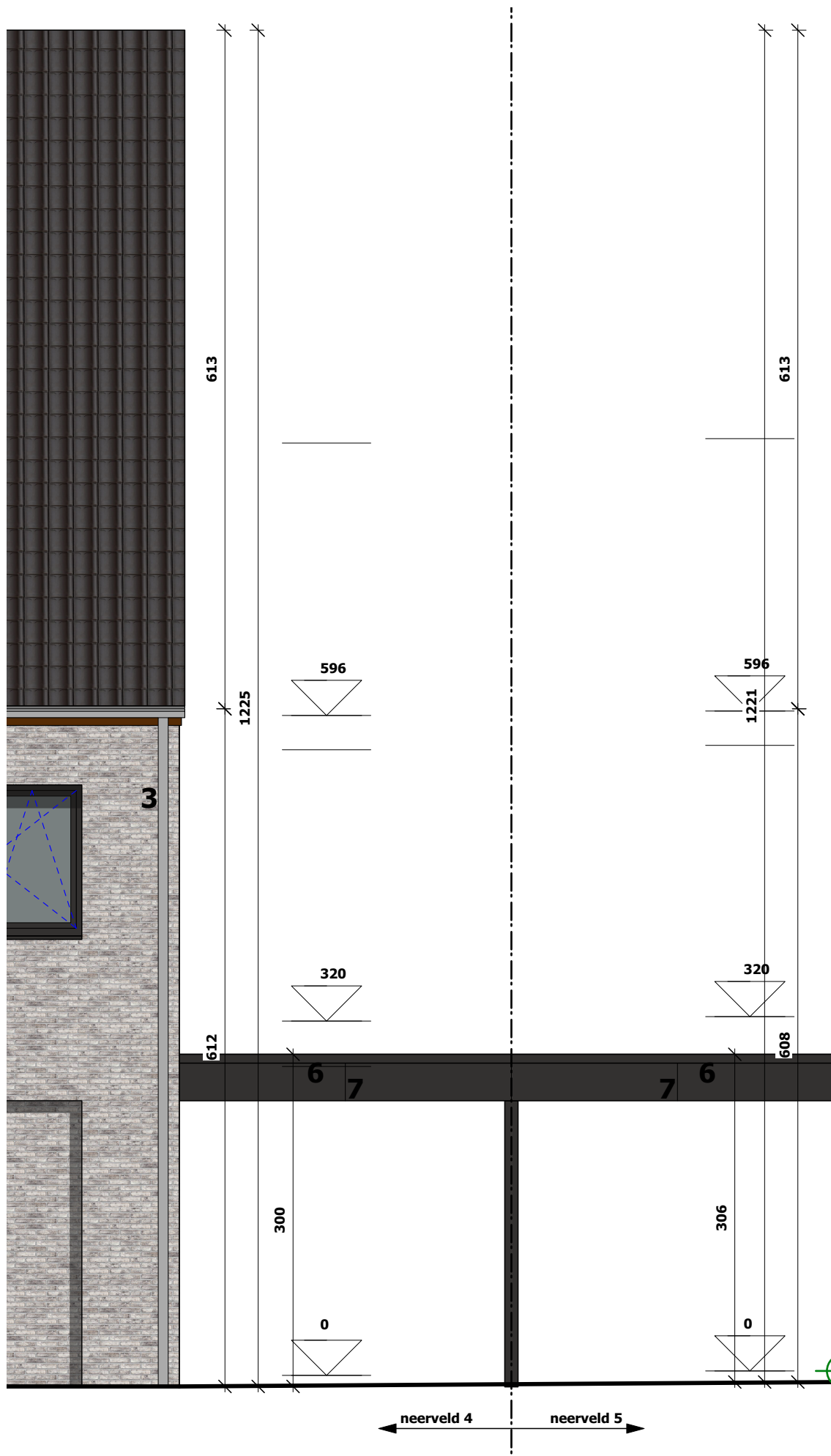



# gevelmaterialen:

1. gevelsteen, lichtgrijs, REGA VDS , toon op toon gevoegd
2. gegolfde dakpan, leikleur
3. aflopen en goten in geprepatineerd quartz-zinc
4. blauwe hardsteen
5. aluminium buitenschrijnwerkerij, gitzwart (RAL 9005)
6. aluminium dakrandprofiel, gitzwart (RAL 9005)
7. trespa, gitzwart (RAL 9005)
8. borstwering in gelaagd glas

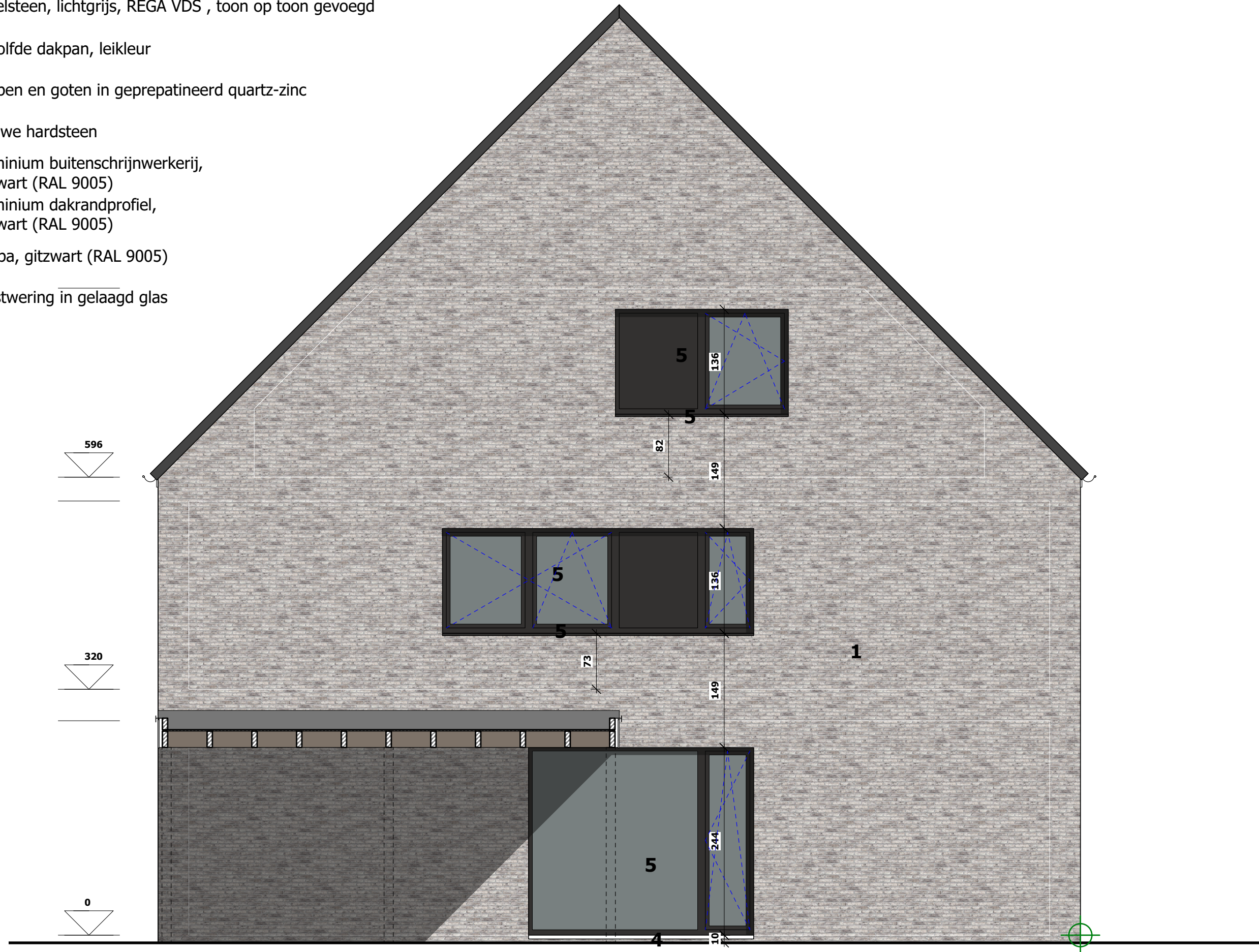

schaal

1/50

Groot Neerveld - OUD-HEVERLEE

LINKERZIJGEVEL / NEERVELD 5

NV KWADRAAT

DOSSIER N. 18.0305.HN

A5.11

11

03/09/2020