

# PLAN DE DIVISION, MESURAGE ET BORNAGE.

Commune de FERNELMONT.

4<sup>e</sup> division / HINGEON.

Section A, partie du n° 213/E.

Lotissement famille HAMOIR délivré le 02 juin 2009.

Ref: PL n° 02/09.

Plan du lot n° 06 bis.

Superficie: Partie du n° 213/E pour 09a 23ca.

## Description de limites:

Voir plan et liste de coordonnées ci-contre.

Ce plan a été réalisé sur base des plans du remembrement pour l'ensemble et d'un plan du Géomètre LATOUR (28/11/78) annexé à un acte des Notaires Yv. Debouche et L. d'Harveng (14/02/79) étant une vente par Vict. Hamoir à Lepine.(214/M/2)

Levé et dressé par le Géomètre Expert Immobilier soussigné  
J-P. DELCORDE, demeurant rue Henri Lemaître, n° 53 à  
5000 Namur. Tel : 081/74.39.74. Fax: 081/74.71.24.  
GSM: 0476/56.33.20. Namur le 07/12/2009.

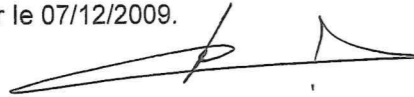
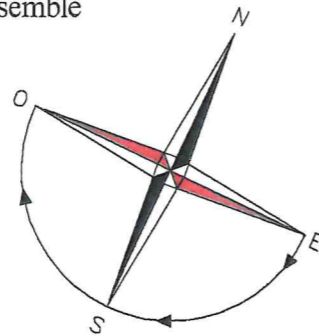





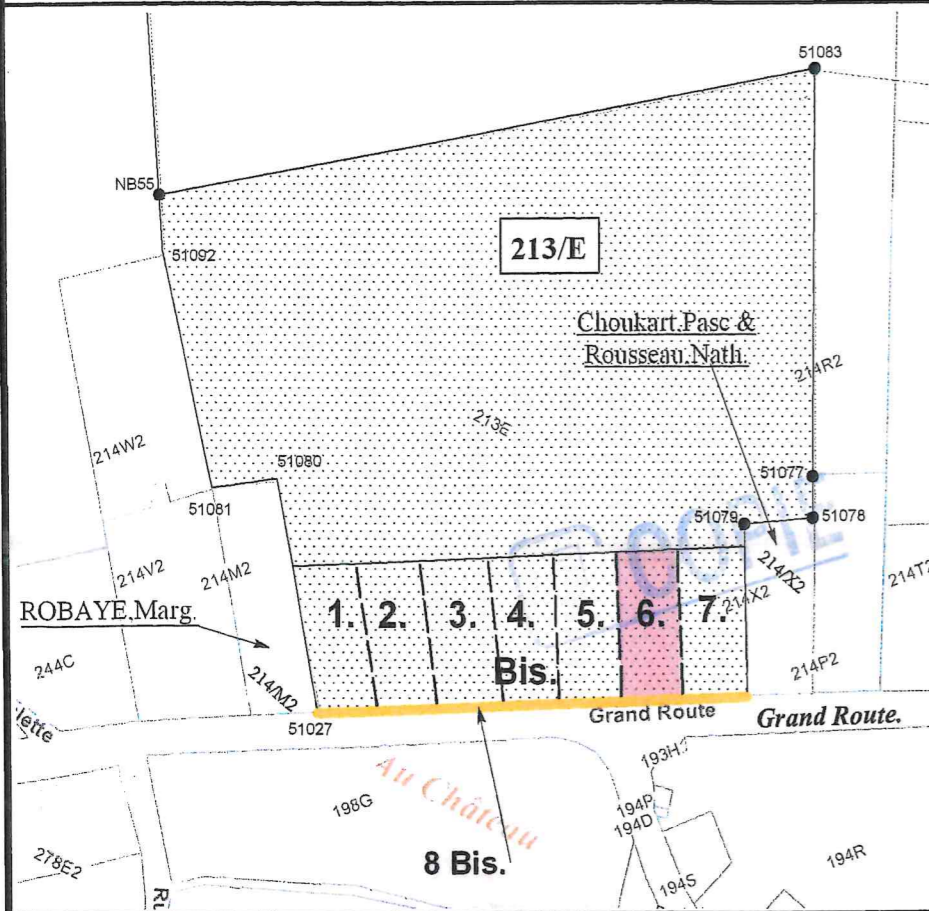



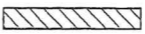

Plan de situation: 1/2500.

Liste des coordonnées.



17	194942.62	135089.58
23	194954.79	135093.15
24	194930.93	135080.25
25	194917.36	135072.94
30	194885.11	135055.44
31	194865.79	135045.02
32	194840.81	135031.44
33	194818.74	135019.50
34	194807.23	135013.24
65	194925.86	135049.41
66	194926.18	135050.09
51027	194816.50	135021.86
51078	194936.98	135152.06
51079	194916.66	135140.91
51080	194769.83	135084.84
51081	194750.80	135072.05
nb1	194834.05	135033.14
nb2	194851.73	135042.68
nb3	194868.79	135051.88
nb4	194815.54	135023.15
nb6	194885.80	135061.05
nb7	194902.79	135070.22
nb9	194941.78	135091.25
nb10	194919.79	135079.39
nb11	194786.41	135062.47
nb12	194809.84	135075.05

## Légende:

- Voirie, asphalté et filet d'eau: 
- Bâti existant: 
- Bornes nouvelles: 
- Bornes existantes: 
- Limite: 
- Limite nouvelle et sommets: 
- Alignement (limite entre domaine public et privé): 
- Clôture existante: 
- Haie vive existante: 
- Support électrique: 
- Chambre de visite: 
- Bouche incendie: 
- Avaloires: 
- Terrain cédé à l'Etat Belge: 

nb13	194830.37	135086.07
nb14	194848.54	135095.82
nb15	194865.96	135105.17
nb16	194882.29	135113.94
nb17	194899.00	135122.91
nb18	194920.05	135134.21
STB1	194894.38	135049.94
51077	194930.58	135165.28
51078	194936.98	135152.06
51083	194871.31	135285.09
23	194954.79	135093.15
24	194930.93	135080.25
25	194917.36	135072.94
26	194913.23	135073.41
27	194900.42	135066.50
29	194887.05	135059.30
30	194885.11	135055.44
31	194865.79	135045.02
32	194840.81	135031.44
33	194818.74	135019.50
34	194807.23	135013.24

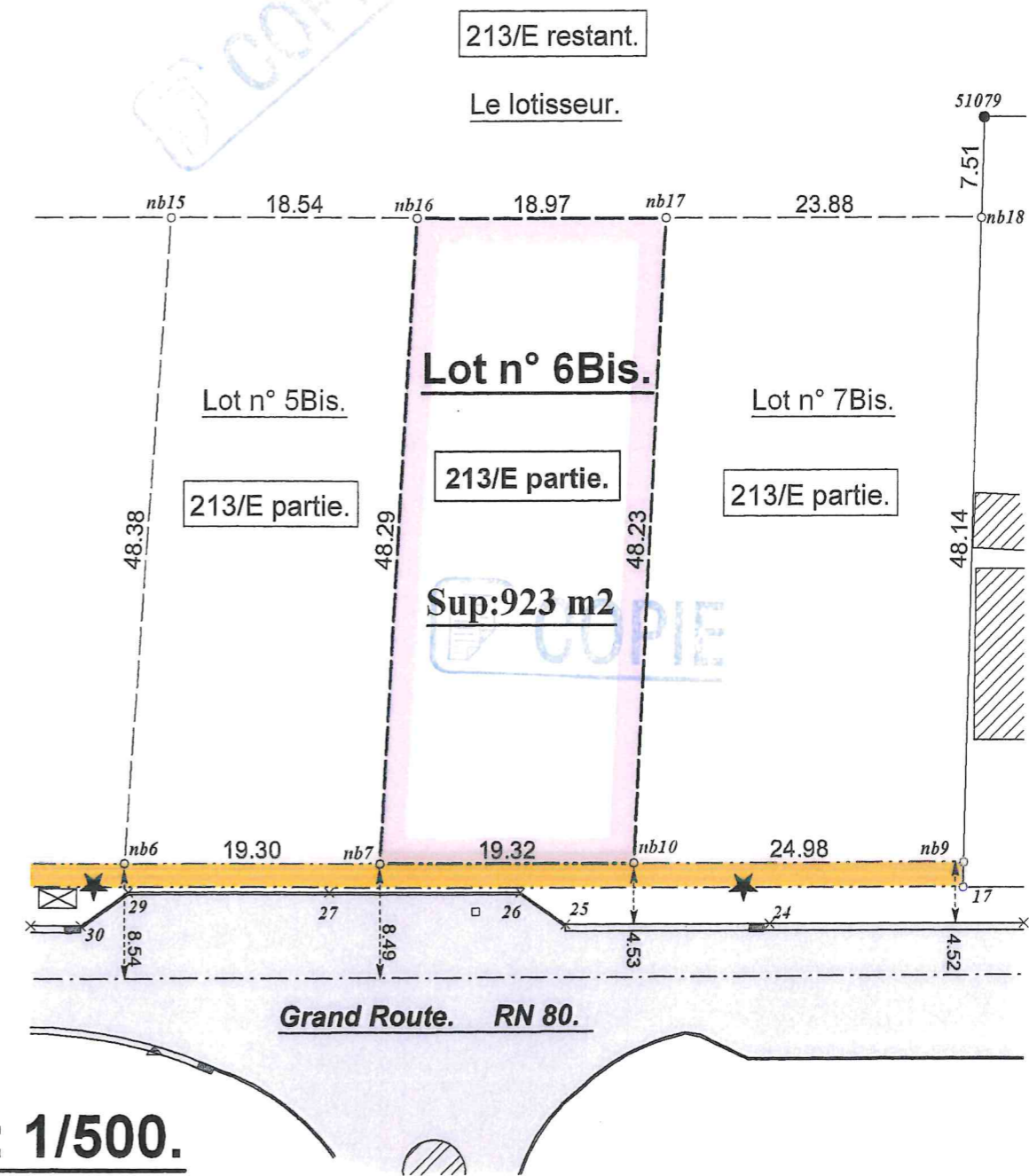

Echelle : 1/500.