

places de parking

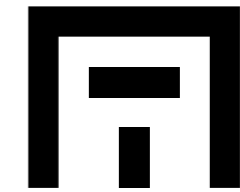

RPV unité 68

version A
date 02-11-2023
échelle 1:1250

promoteur

BVI.EU sa
prins boudewijnlaan 7c/bus 0201
2550 Kontich

+32 (0)3 355 09 09
info@bvi.eu



informations sur le projet

PME
rue du panier vert
1400 nivelles



architecte

mortelmans van tricht architecten
hospitaalplein 11/002
2018 antwerpen

+32 3 321 45 41
info@mortelmansvantricht.be

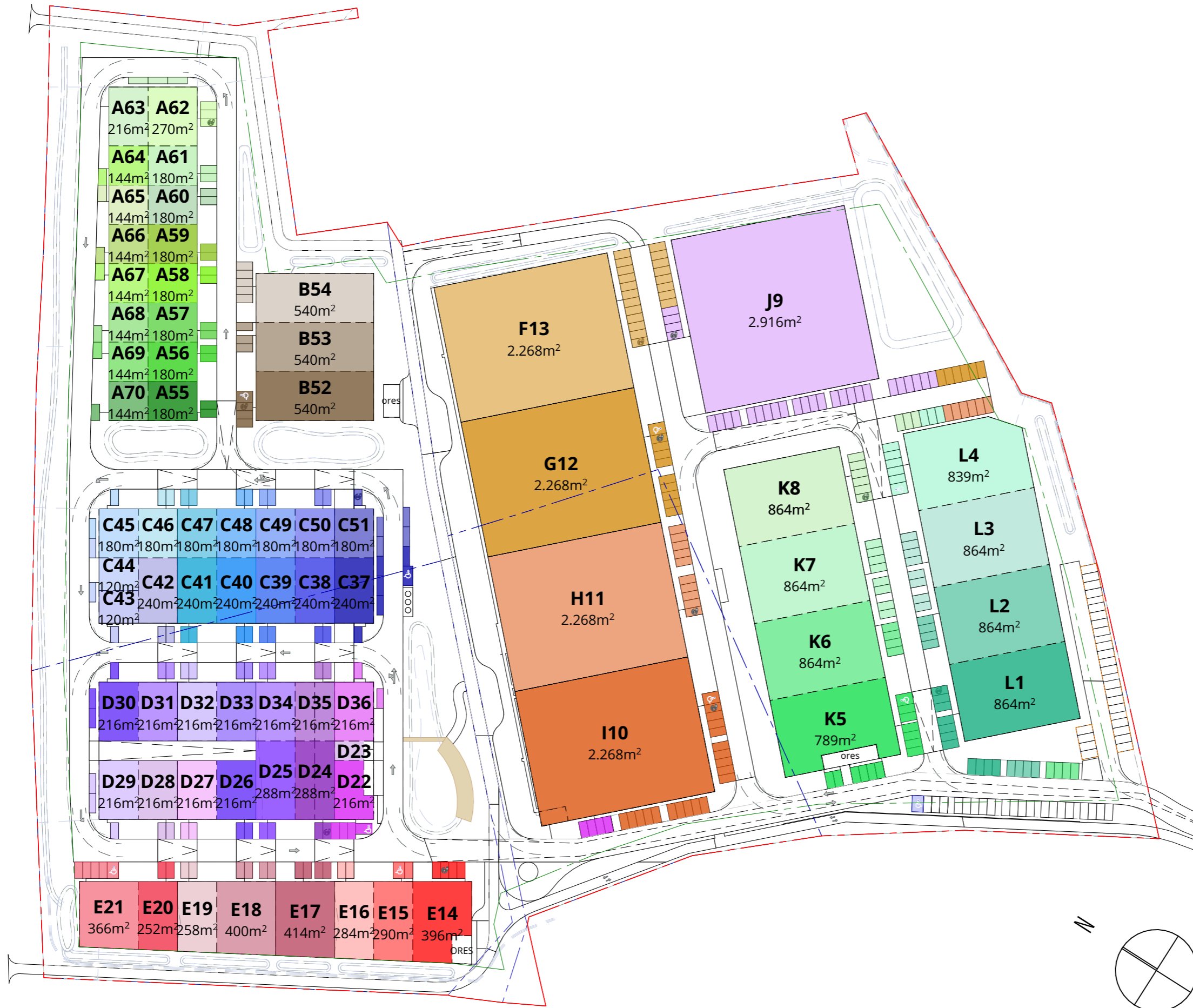

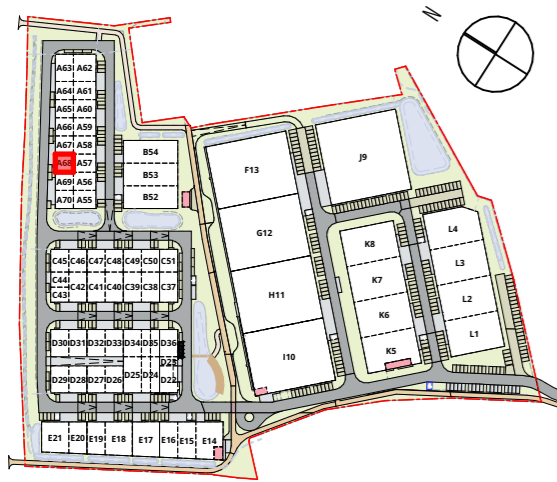

implantation 1/5000

plan rdc

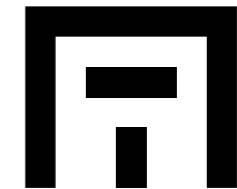

RPV
unité 68

version A
date 02-11-2023
échelle 1:100

promoteur

BVI.EU sa
prins boudewijnlaan 7c/bus 0201
2550 Kontich

+32 (0)3 355 09 09
info@bvi.eu



informations sur le projet

PME
rue du panier vert
1400 nivelles



architecte

mortelmans van tricht architecten
hospitaalplein 11/002
2018 antwerpen

+32 3 321 45 41
info@mortelmansvantricht.be

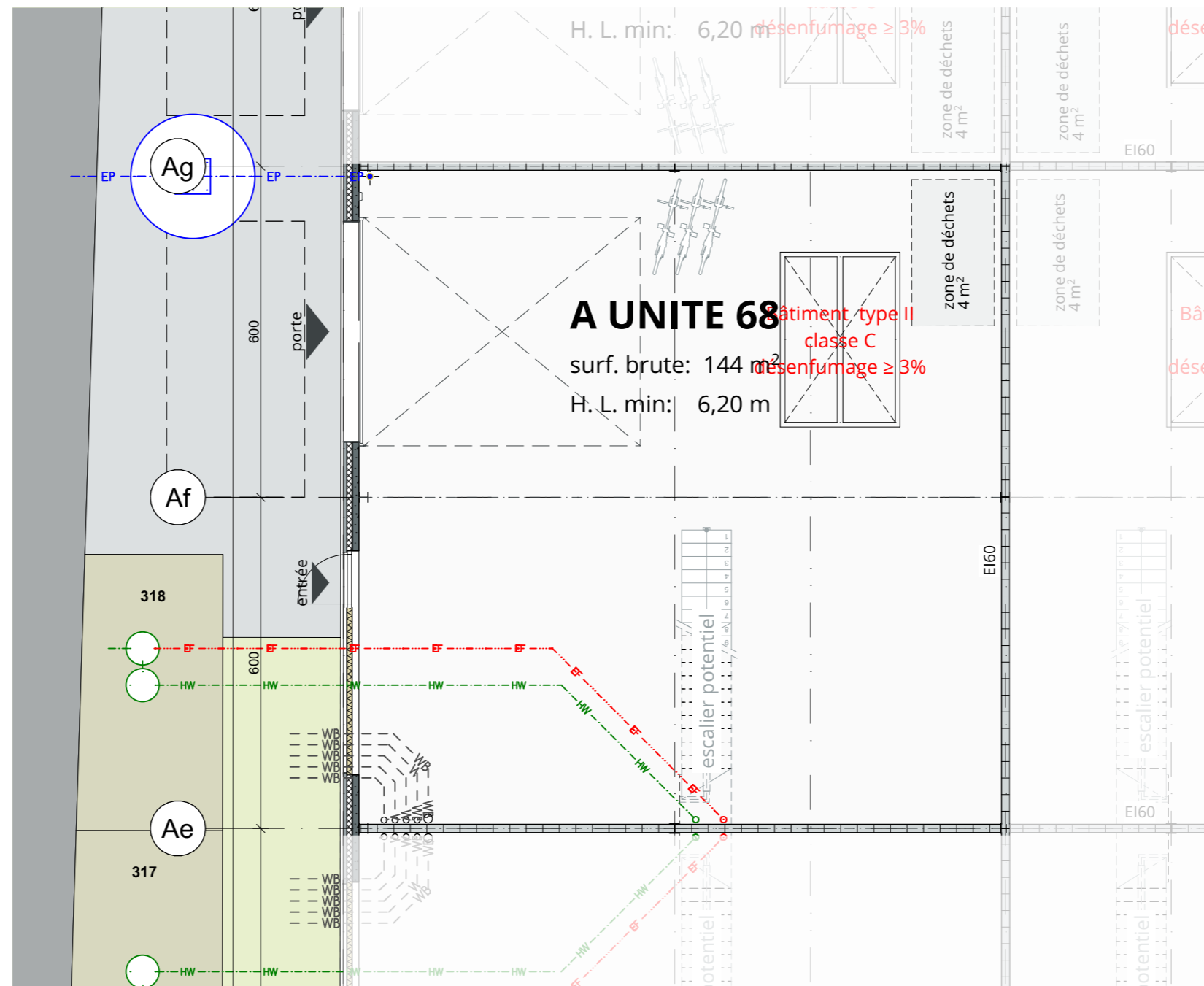

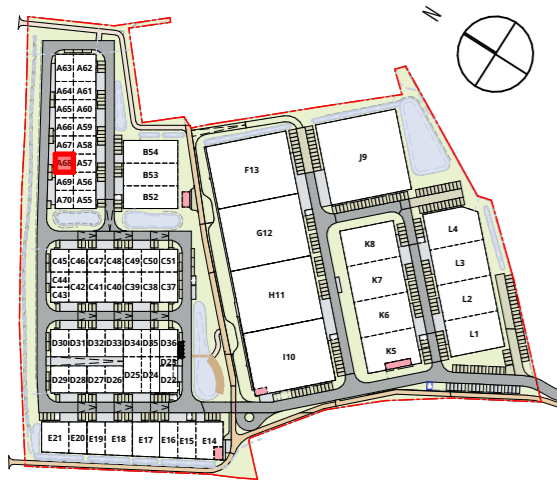

implantation 1/5000

plan toiture

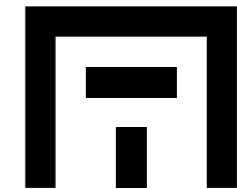

RPV unité 68

version A
date 02-11-2023
échelle 1:100

promoteur

BVI.EU sa
prins boudewijnlaan 7c/bus 0201
2550 Kontich

+32 (0)3 355 09 09
info@bvi.eu



informations sur le projet

PME
rue du panier vert
1400 nivelles





architecte



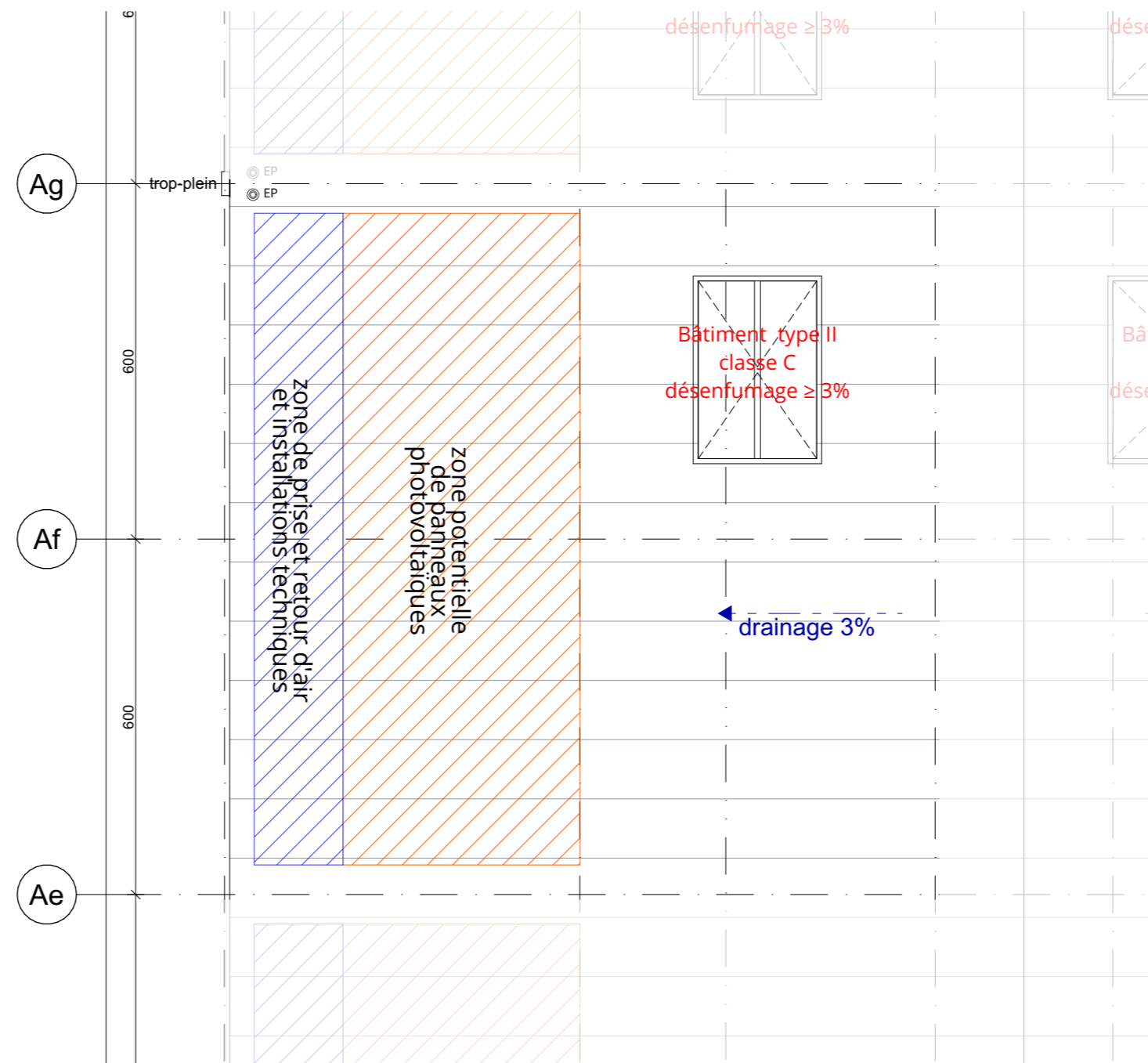





mortelmans van tricht architecten
hospitaalplein 11/002
2018 antwerpen



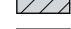

+32 3 321 45 41
info@mortelmansvantricht.be

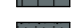
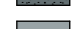













légende des matériaux - plans et coupes

-  parement a
-  parement b
-  parement c

-  bloc treillis
-  blocs de béton
-  pierre naturelle
-  béton cellulaire
-  blocs de plâtre
-  brique silico-calcaire
-  brique en silicate
-  béton armé
-  béton préfabriqué
-  béton de construction
-  béton apparent

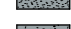
-  dalles de béton
-  tissus précontraints
-  dalle de compression en béton
-  précontrainte

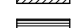
-  isolation - XPS
-  isolation - PIR PUR
-  isolation du sol - projetée PUR
-  isolation - EPS
-  isolation - laine de verre
-  isolation - laine de roche
-  isolation - verre mousse

-  chape
-  bande vulcanisée
-  béton incliné
-  bois feuillus
-  bois de conifères
-  multiplex

- 1a. profil de couvre-mur en aluminium, ton blanc
- 1b. plaque murale en aluminium, ton blanc
- 1c. profilé Z en aluminium, ton blanc
- 2a. panneaux sandwich isolés, ton blanc
- 2b. panneaux sandwich isolés, ton gris clair
03. béton préfabriqué isolé, ton gris clair
- 4a. menuiserie extérieure en aluminium, ton gris-blanc
- 4b. menuiserie extérieure en aluminium, ton bronze
05. porte sectionnelle, ton gris-blanc
- 6a. seuil en pierre bleue
- 6b. seuil en aluminium, ton gris-blanc
- 6c. seuil en aluminium, ton bronze
- 7a. pare-soleil verticales en aluminium gris clair ou blanc
- 7b. volet en aluminium perforé, ton vert clair
08. éléments béton ou cassette métallique, ton gris clair
09. numéro de bâtiment avec éclairage
10. éclairage
11. lucarne/ coupole
12. trappe à désenfumage
13. trop plein, ton blanc
14. zone d'enseigne
15. garde-corps, ton bronze
16. poteaux de protection
17. panneau photovoltaïque
18. bardage en bois
19. treillage en aluminium avec végétation

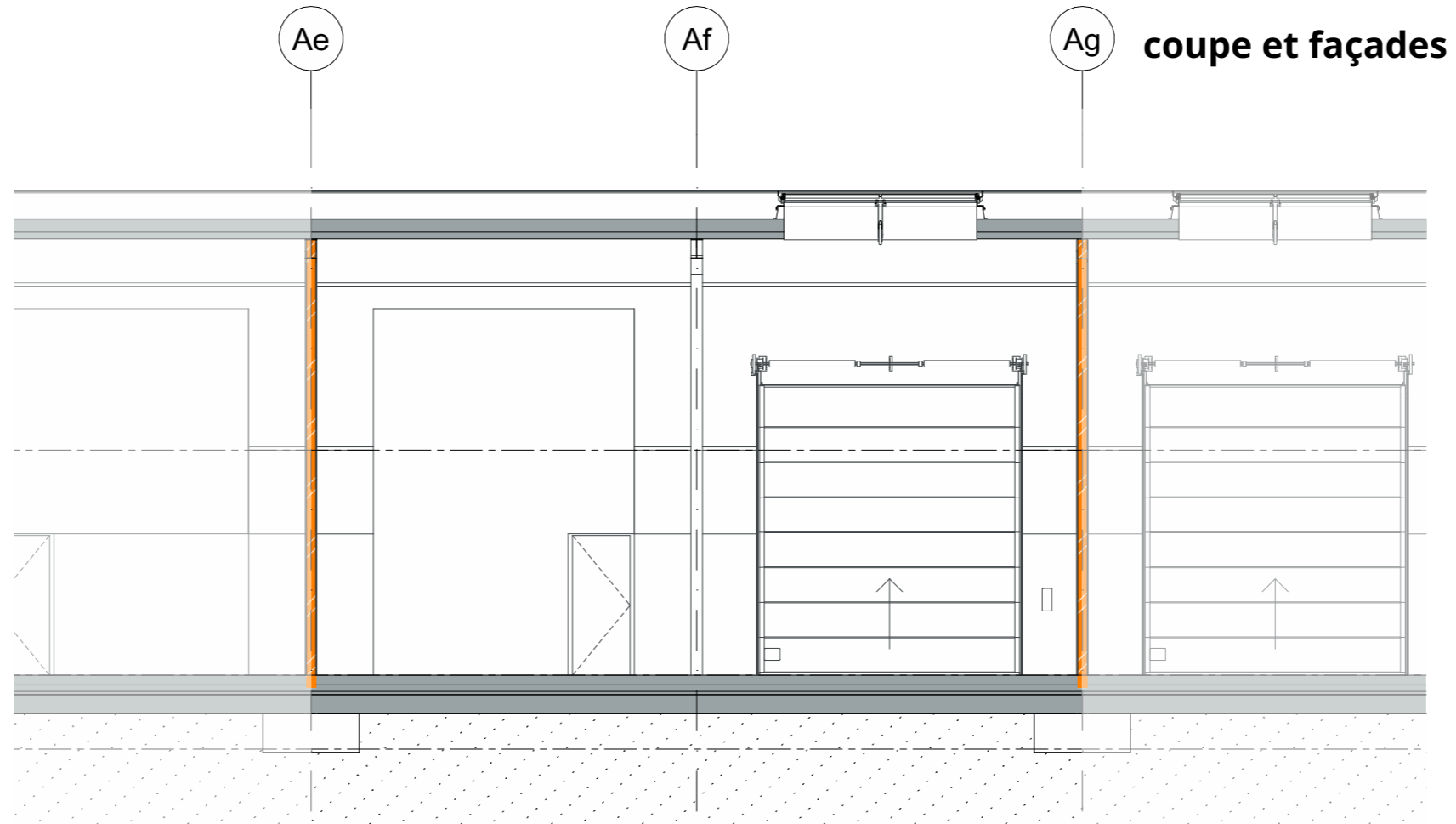

Bat. A coupe 3

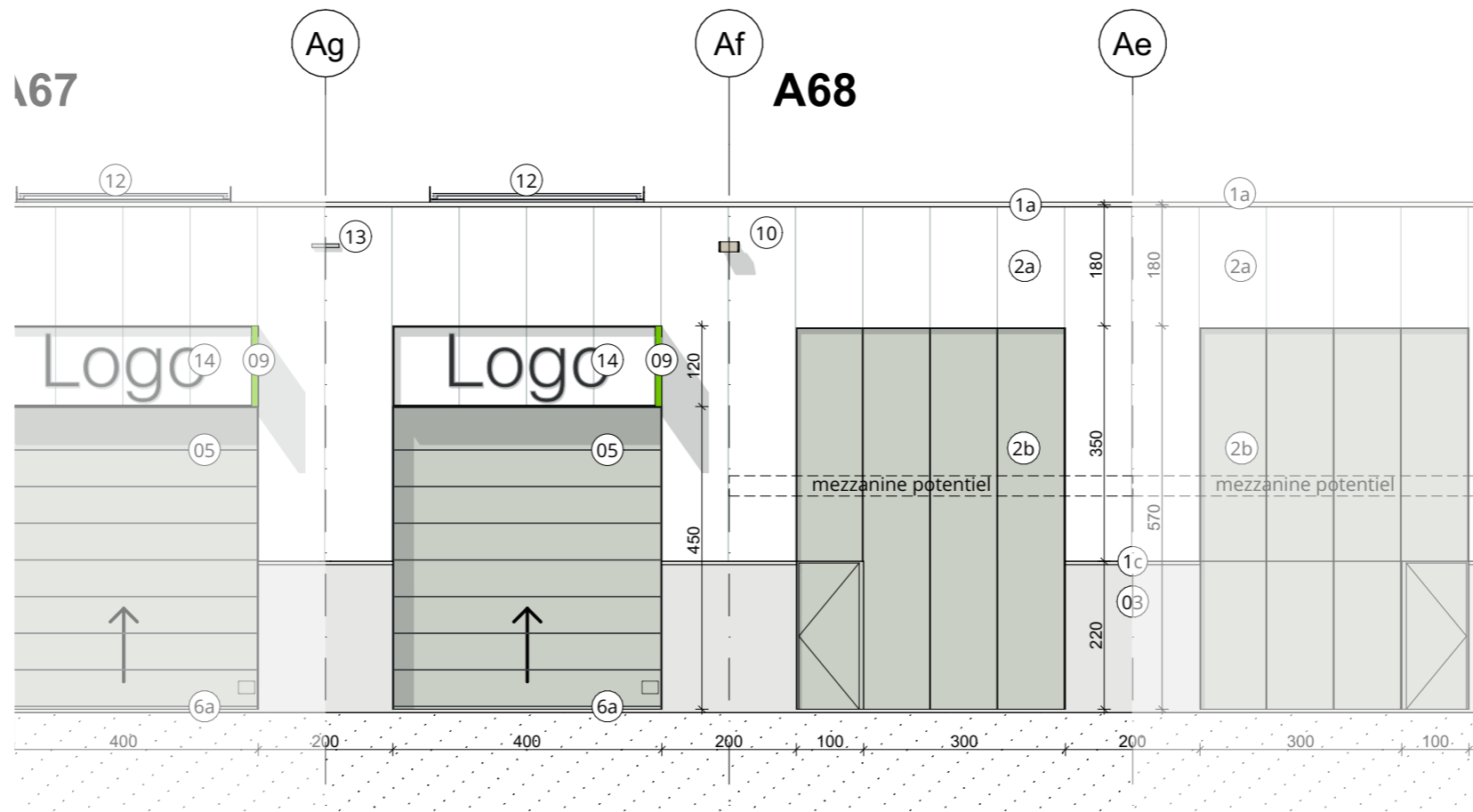

façade gauche

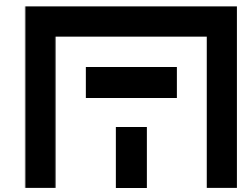

RPV
unité 68

version A
date 02-11-2023
échelle 1:100

promoteur

BVI.EU sa
prins boudewijnlaan 7c/bus 0201
2550 Kontich

+32 (0)3 355 09 09
info@bvi.eu



informations sur le projet

PME
rue du panier vert
1400 nivelles



architecte

mortelmans van tricht architecten
hospitaalplein 11/002
2018 antwerpen

+32 3 321 45 41
info@mortelmansvantricht.be

façade modulaire

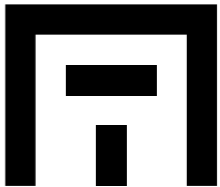

RPV unité 68

version A
date 02-11-2023
échelle 1:100

promoteur

BVI.EU sa
prins boudewijnlaan 7c/bus 0201
2550 Kontich

+32 (0)3 355 09 09
info@bvi.eu



informations sur le projet

PME
rue du panier vert
1400 nivelles



architecte

mortelmans van tricht architecten
hospitaalplein 11/002
2018 antwerpen

+32 3 321 45 41
info@mortelmansvantricht.be

- 1a. profil de couvre-mur en aluminium, ton blanc
- 1b. plaque murale en aluminium, ton blanc
- 1c. profilé Z en aluminium, ton blanc
- 2a. panneaux sandwich isolés, ton blanc
- 2b. panneaux sandwich isolés, ton gris clair
- 03. béton préfabriqué isolé, ton gris clair
- 4a. menuiserie extérieure en aluminium, ton gris-blanc
- 4b. menuiserie extérieure en aluminium, ton bronze
- 05. porte sectionnelle, ton gris-blanc
- 6a. seuil en pierre bleue
- 6b. seuil en aluminium, ton gris-blanc
- 6c. seuil en aluminium, ton bronze
- 7a. pare-soleil verticales en aluminium gris clair ou blanc
- 7b. volet en aluminium perforé, ton vert clair
- 08. éléments béton ou cassette métallique, ton gris clair
- 09. numéro de bâtiment avec éclairage
- 10. éclairage
- 11. lucarne/ coupole
- 12. trappe à désenfumage
- 13. trop plein, ton blanc
- 14. zone d'enseigne
- 15. garde-corps, ton bronze
- 16. poteaux de protection
- 17. panneau photovoltaïque
- 18. bardage en bois
- 19. treillage en aluminium avec végétation

VARIANTE 1

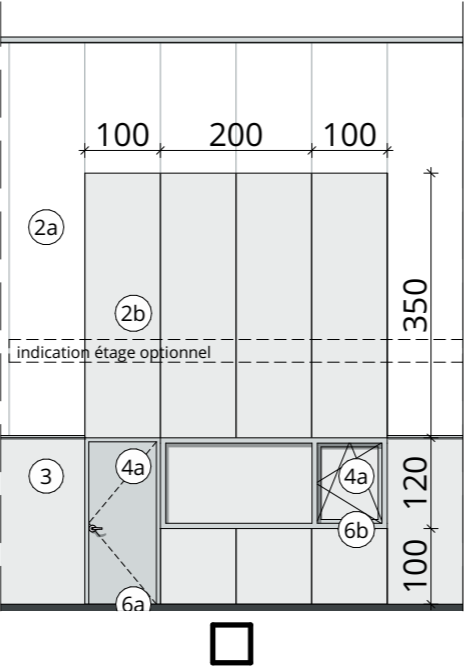

VARIANTE 2

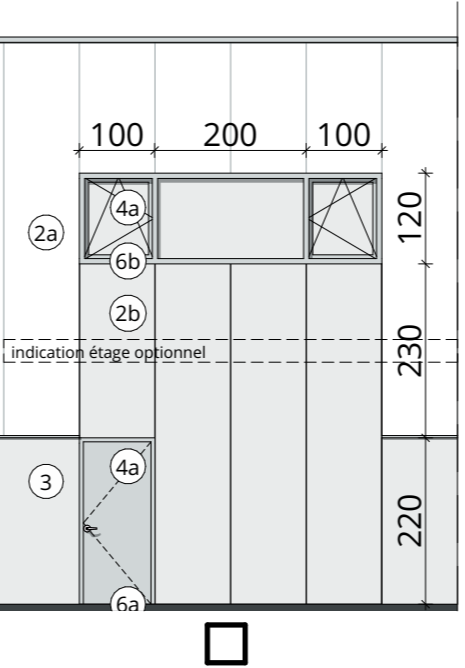

VARIANTE 3

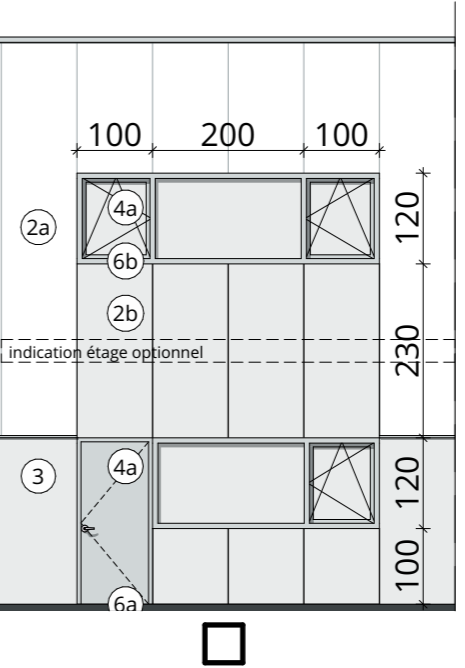

BASE

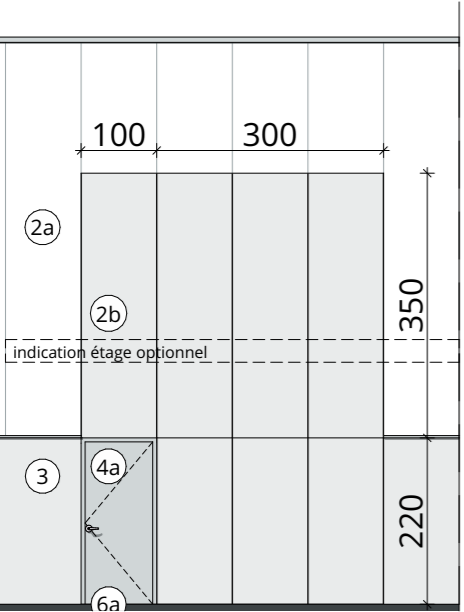

VARIANTE 4

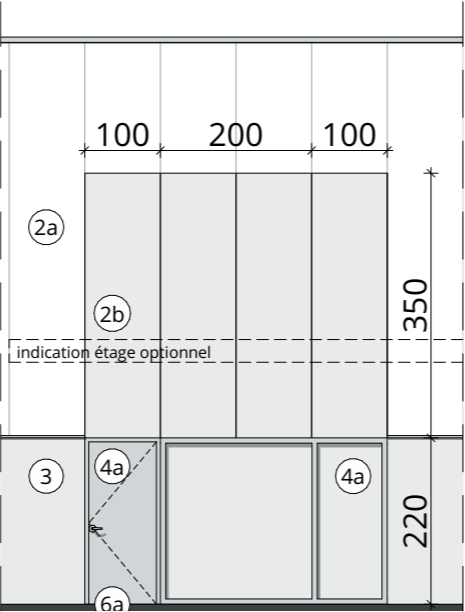

VARIANTE 5

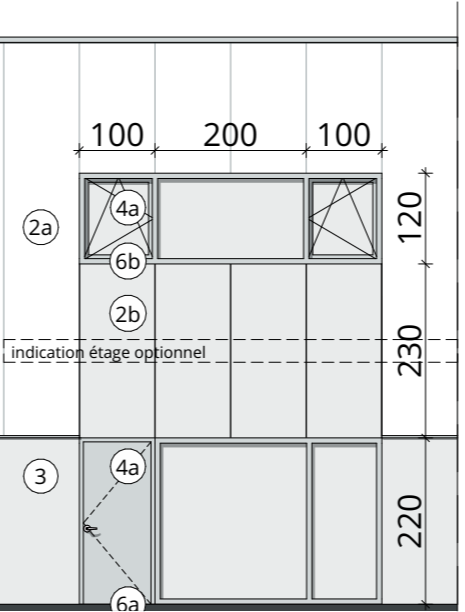

VARIANTE 6

